

V7 sand plant specifications	V7-40	V7-60	V7-120	V7-240
Processing capacity (TPH)	40	60	120	240
Power usage (kW normal)	290	380	760	1,520
Power usage (kW peak)	450	550	1,000	1,900

V'Sepa screen specifications	RCAS 900	RCAS 1200	RCAS 1900	RCAS 2500
Power (kW)	40	55	65	95
Capacity (tph)	90	120	190	250

Notes:

1. Actual performance determination is carried out by screening test.
2. V'Sepa required power does not include the ancillaries such as a compressor for the dust collector.
3. Capacity may vary with feed gradation, separation size, moisture, etc.
4. The above guide capacities can be expected with dry feed material of bulk density 1.6t/m<sup>3</sup>

## V7 - 40

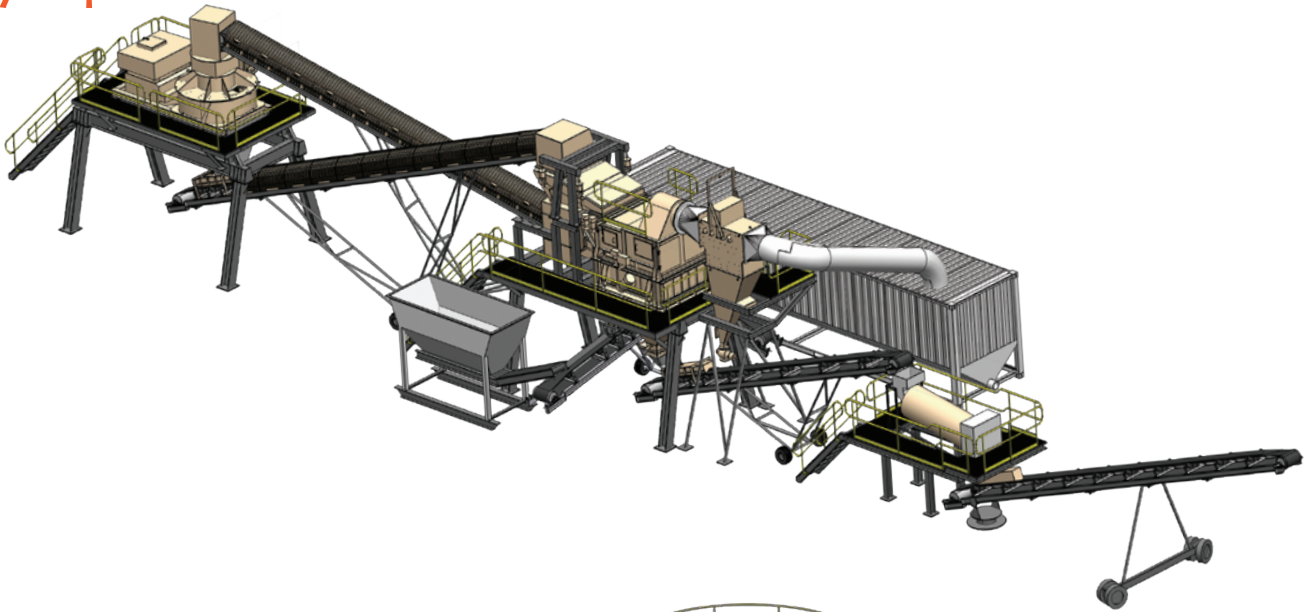

## V7 - 60

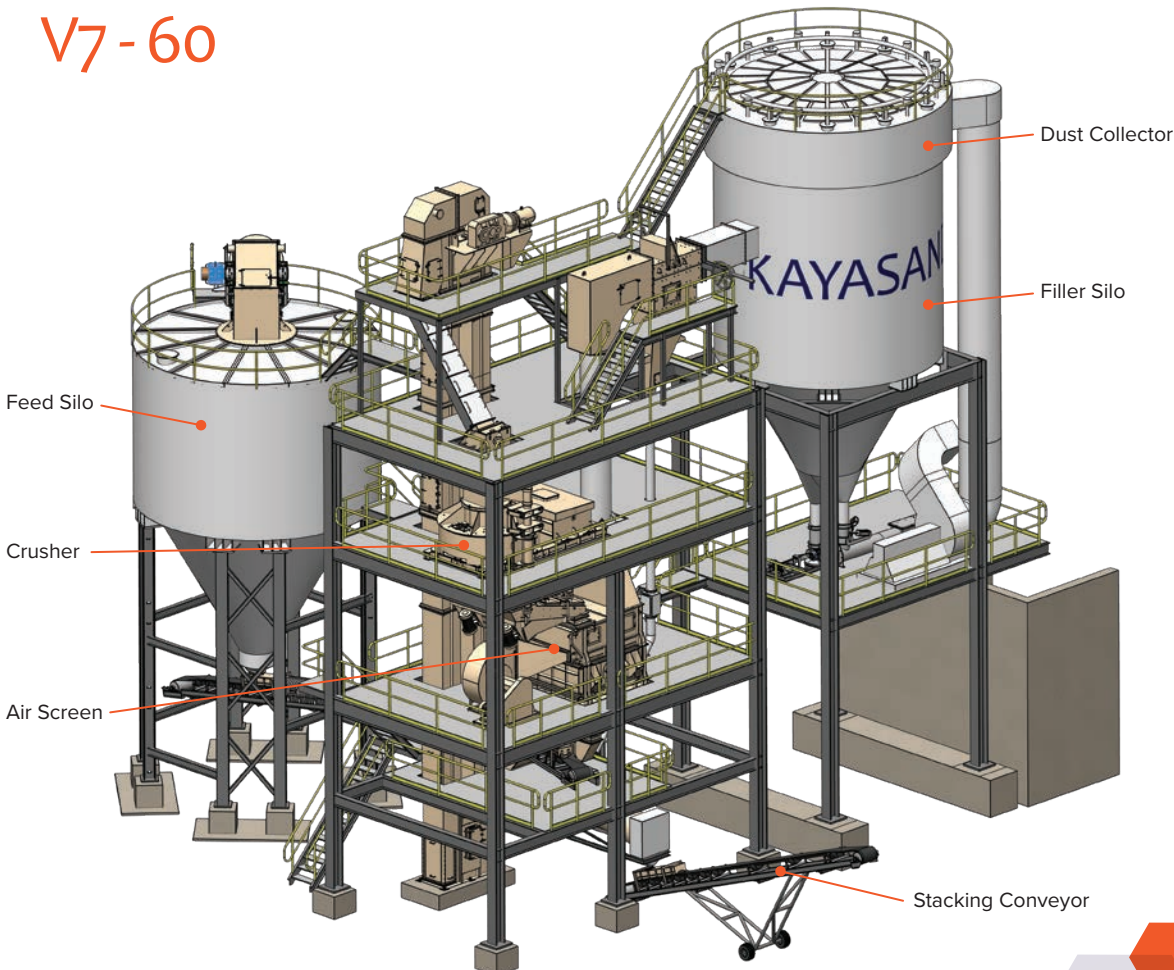

V7 - 120

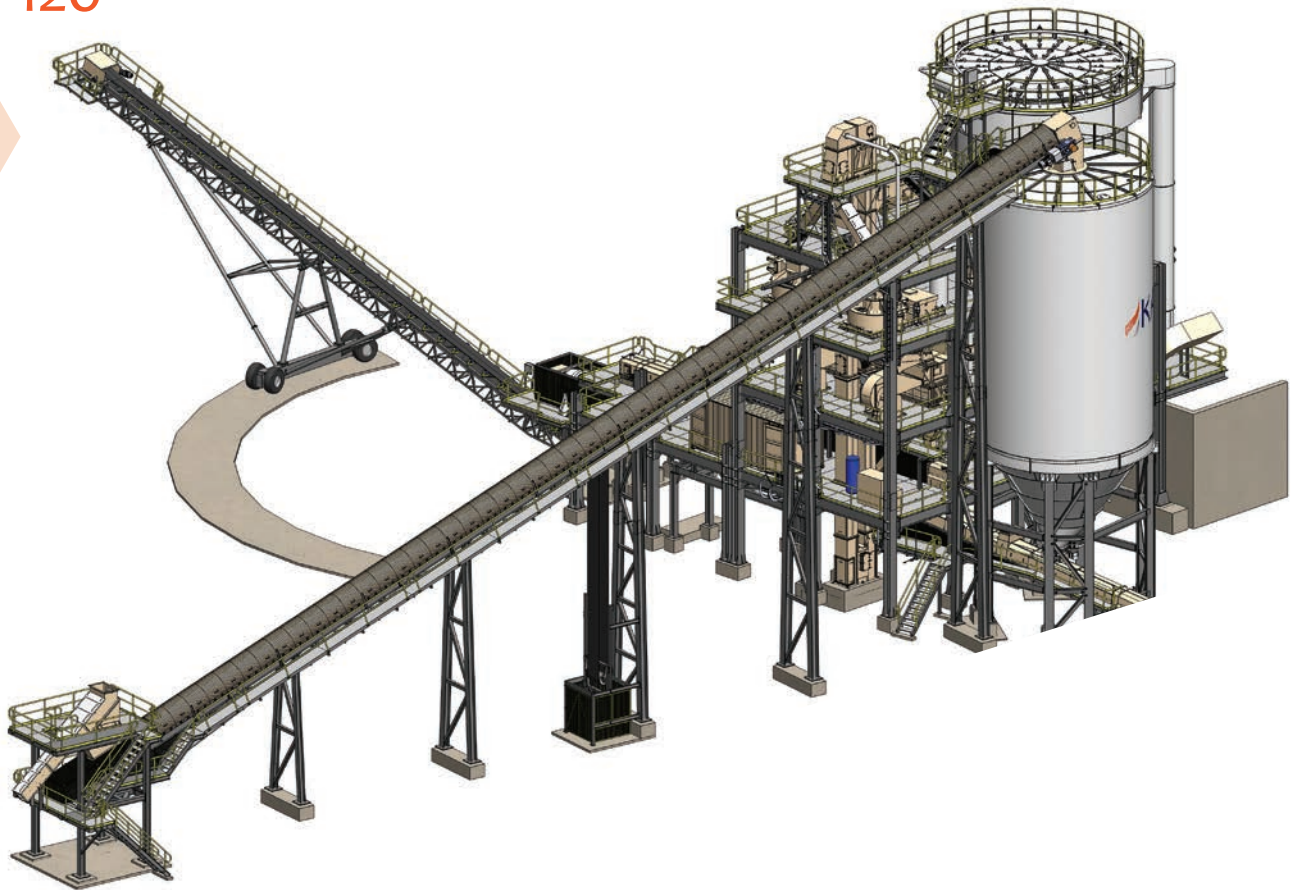

V7 - 240

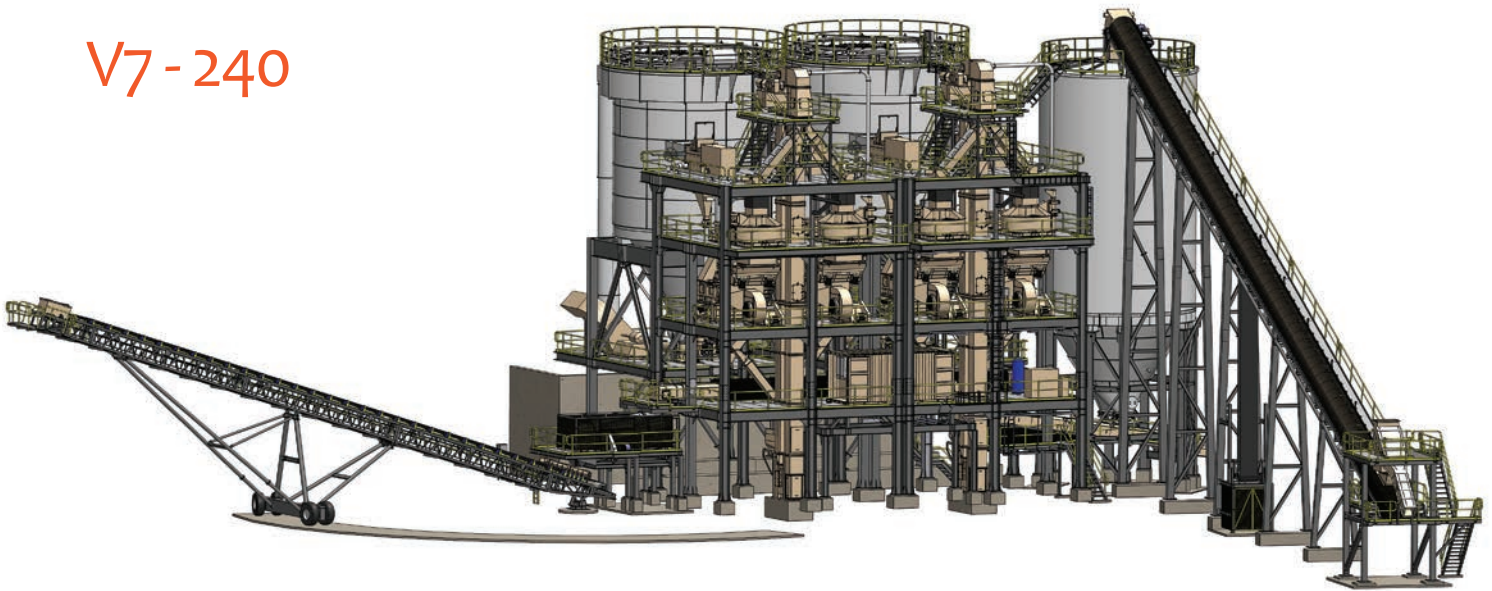

**KAYASAND**  
Sand Manufacturing & Fine Aggregate Separation

NZ +64 21 848 786  
18 Mexted Place, Riverlea  
Hamilton, 3216 New Zealand  
info@kayasand.com

AUS +61 2 8007 4828  
PO Box 104, Albion Park  
NSW, 2527, Australia  
info@kayasand.com

Equipment supplied by  
**KEMCO**

**KAYASAND.COM**